

October 29, 2018

Renderings revealed: ESJ Capital unveils Jungle Island hotel & more

Developers also released renderings for Avery Pompano Beach, Shoma Village and East River Living

By [Amanda Rabines](#) | October 29, 2018 04:30PM



Avery Pompano Beach exterior rendering



Avery Pompano Beach pool rendering

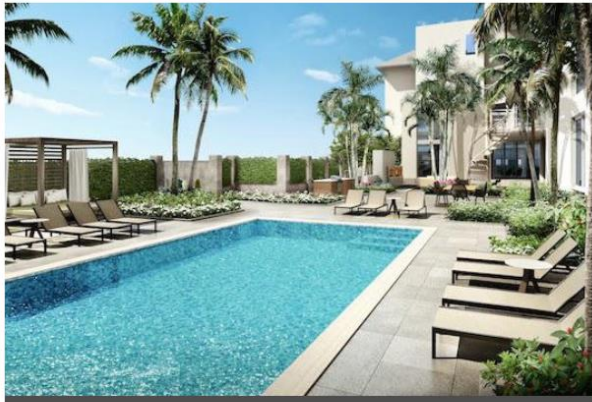

Avery Pompano Beach pool rendering

New renderings for Jungle Island hotel

After receiving [voter approval](#), ESJ Capital Partners released a slew of renderings for its proposed Jungle Island hotel.

The vote allowed the Aventura-based developer to extend its lease to 39 years, plus a 15-year option, for the planned 300-room hotel. ESJ recently submitted plans to the city of Miami for construction of the project.

ESJ closed on the initial \$60 million lease transfer of the 18-acre Watson Island theme park in April 2017. The property, which closed due to damage caused by Hurricane Irma last year, has been reopening in phases.

New attractions include a newly installed vertical wind tunnel, a Nerf foam dart challenge course and two escape rooms featuring Jungle Island themes.

Meyers Group releases renderings for Avery Pompano Beach

In the midst of commencing leasing of its new tech-oriented boutique apartment project Avery Pompano Beach, developer Meyers Group also released some new renderings.

[Avery Pompano Beach](#) topped off in August. It includes 144 rental units ranging in size from 787 square feet to 1,436 square feet with prices starting at \$1,750 a month. The project is slated to open in March 2019. It's located on the corner of Federal Highway and Northeast Fourth Street.

Designed by Salazar Architectural Group, amenities include a waterfall, game room, theater, multiple fitness facilities and a private clubhouse with a pool and sundeck.

Shoma Group releases renderings for new Hialeah project

Shoma Group released renderings for its planned 304-unit apartment complex in Hialeah called [Shoma Village](#).

Converting an old shopping center into a new rental development, the project at 401 and 435 Hialeah Drive will feature a 7-story parking garage and more than 30,000 square feet of retail space fronting the apartments.

Renderings show Shoma Village will feature a fitness facility, pool and dog park.

Habitat Group announces new East River Living project

Picking up on the momentum of the Miami River District, Habitat Group recently announced a new 34-unit apartment building, East River Living.

The building at 39 Northwest Seventh Avenue in Little Havana will sit along the west side of the Miami River. It is designed by Hernando Carrillo of HAC Architects & Urbanists and features a pool surrounded by greenery and a private gym.

[The building](#) is expected to be completed at the end of 2019.